

THIS DRAWING IS UNPUBLISHED. RELEASED FOR PUBLICATION
 © COPYRIGHT BY TYCO ELECTRONICS CORPORATION. ALL RIGHTS RESERVED.

Loc	DIST	REVISIONS			
P	LTR	DESCRIPTION	DATE	DWN	APVD
FT	0	AS1	REVISED PER ECO-06-9350	4/26/06	SS GS

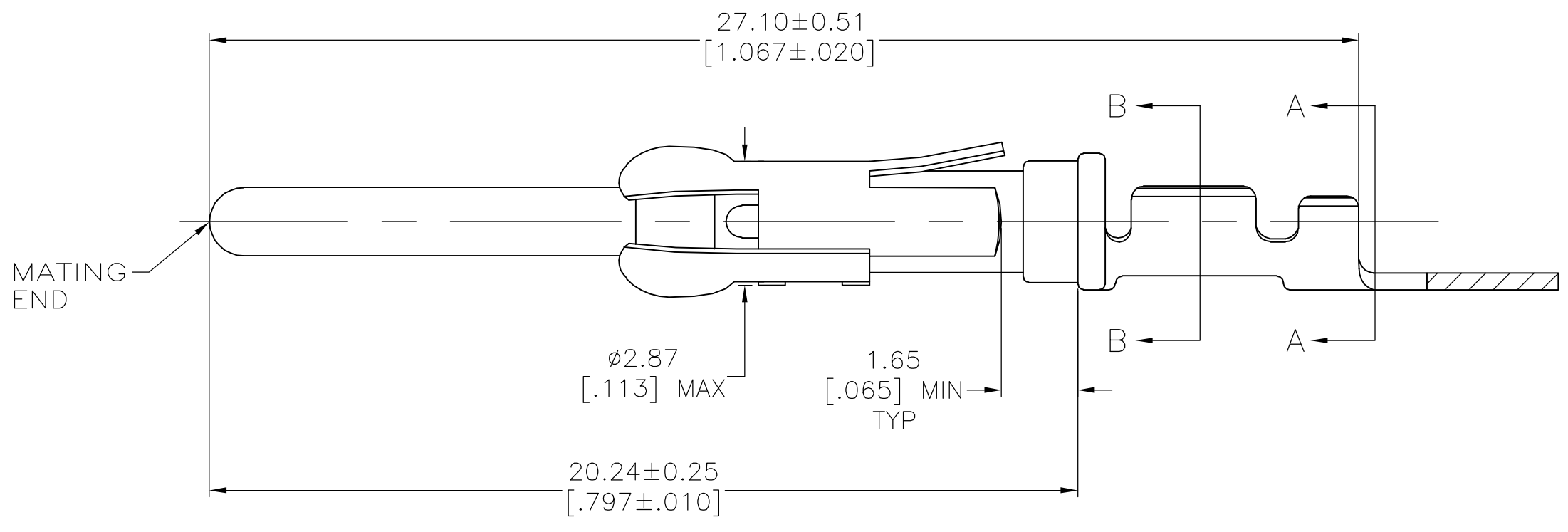
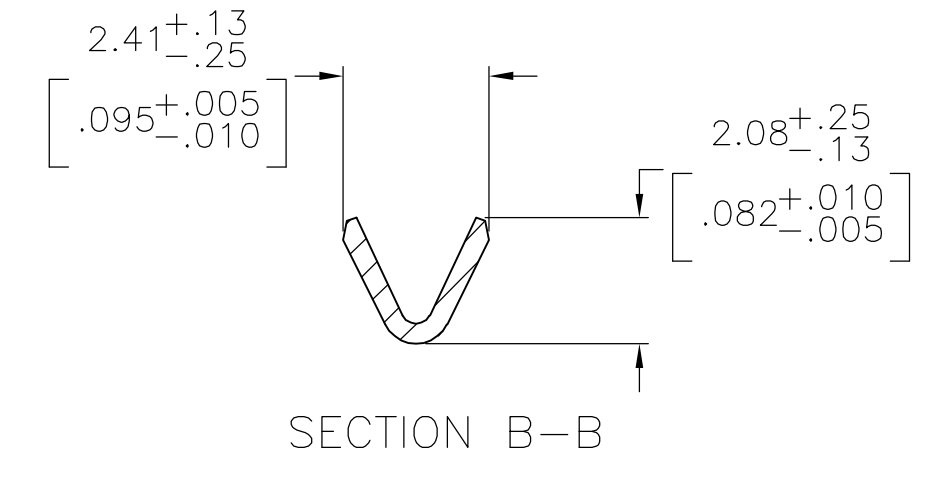
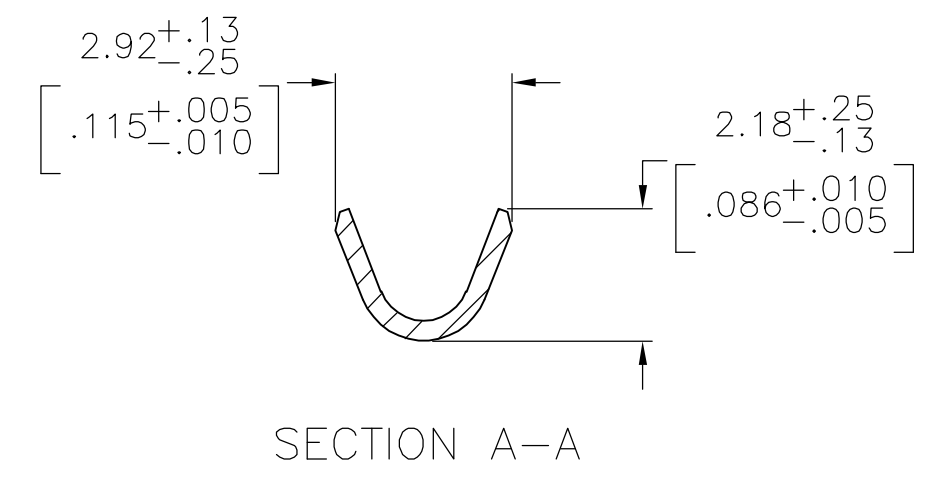
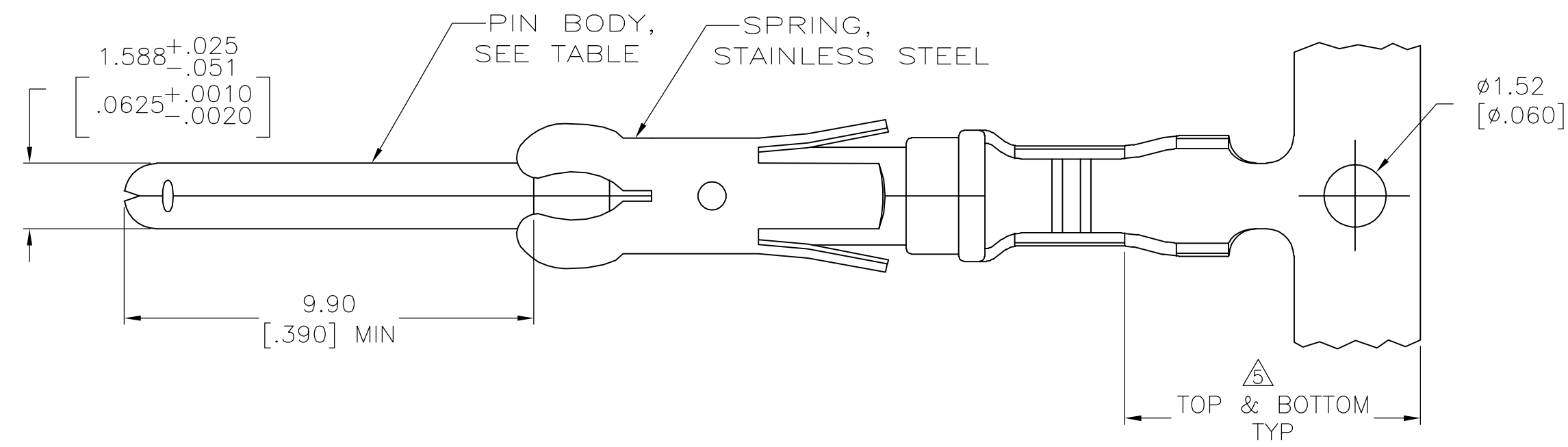

- 1 REVERSE REELED FOR MINI-APPLICATOR.
- 2 0.76um [.000030] MIN GOLD PER MIL-G-45204 ON MATING END FOR A LENGTH OF 5.08 [.200] MIN WITH GOLD FLASH ON THE REMAINDER, OVER 1.27um [.000050] MIN NICKEL PER QQ-N-290.
- 3 0.76um [.000030] MIN GOLD PER MIL-G-45204 IN MATING END FOR A LENGTH OF 5.08 [.200] MIN WITH A UNIFORM GRADIENT TO 0.25um [.000010] MIN GOLD PER MIL-G-45204 ON THE REMAINDER, OVER 1.27um [.000050] MIN NICKEL PER QQ-N-290.
- 4 0.38um [.000015] MIN GOLD PER MIL-G-45204 ON MATING END FOR A LENGTH OF 5.08 [.200] MIN WITH GOLD FLASH ON THE REMAINDER OVER 1.27um [.000050] MIN NICKEL PER QQ-N-290.
- 5 GOLD PLATING NEED NOT APPEAR IN THIS AREA.
- 6 1.27um [.000050] MIN GOLD PER MIL-G-45204 ON MATING END FOR A LENGTH OF 5.08 [.200] MIN WITH GOLD FLASH ON THE REMAINDER OVER 1.90um [.000075] MIN NICKEL PER QQ-N-290.
- 7 1.27um [.000050] MIN TIN-LEAD PER MIL-T-10727 OVER 1.27um [.000050] MIN NICKEL PER QQ-N-290.
- 8 WIRE RANGE 24-20 AWG.
- 9 INSULATION RANGE 1.02 [.040]-2.03 [.080] DIA.
- 10 0.38um [.000015] MIN GOLD PER MIL-G-45204 ON MATING END FOR A LENGTH OF 5.08 [.200] MIN, 1.27um [.000050] MIN TIN-LEAD PER MIL-T-10727 FOR A LENGTH OF 5.69 [.224] MIN ON OPPOSITE END, BOTH OVER 1.27um [.000050] MIN NICKEL PER QQ-N-290 ON ENTIRE CONTACT.
- 11 1.27um [.000050] MIN TIN PER MIL-T-10727 OVER 1.27um [.000050] MIN NICKEL PER QQ-N-290.
- 12 0.38um [.000015] MIN GOLD PER MIL-G-45204 ON MATING END FOR A LENGTH OF 5.08 [.200] MIN, 1.27um [.000050] MIN TIN FOR A LENGTH OF 5.69 [.224] MIN ON OPPOSITE END, BOTH OVER 1.27um [.000050] MIN NICKEL PER QQ-N-290 ON ENTIRE CONTACT.

	1	12	BRASS	-	2-66102-7
	STANDARD	11	BRASS	1-66103-8	2-66102-6
	1	11	BRASS	1-66103-8	2-66102-5
	1	10	BRASS	1-66103-3	2-66102-3
	1	2	PHOSPHOR BRONZE	1-66103-2	2-66102-2
OBSOLETE	1	7	PHOSPHOR BRONZE	1-66103-1	2-66102-1
OBSOLETE	1	6	BRASS	1-66103-0	1-66102-7
	1	2	BRASS	66103-4	66102-9
	1	4	BRASS	66103-3	66102-8
	1	7	BRASS	66103-2	66102-7
	1	3	BRASS	66103-1	66102-6
STANDARD		2	BRASS	66103-4	66102-4
STANDARD		4	BRASS	66103-3	66102-3
STANDARD		7	BRASS	66103-2	66102-2
STANDARD		3	BRASS	66103-1	66102-1
REELING	PIN BODY FINISH		PIN BODY	LOOSE PIECE REF	PART NO

THIS DRAWING IS A CONTROLLED DOCUMENT.

DIMENSIONS: mm	TOLERANCES UNLESS OTHERWISE SPECIFIED:	DWN V. FURLER 11JUL03	Tyco Electronics Corporation Harrisburg, Pa 17105-3608
0 PLC ± -	1 PLC ± -	CHK G. STEINHAUER 11JUL03	
	2 PLC ± 0.13 [.005]	APVD G. STEINHAUER 11JUL03	NAME PIN ASSEMBLY, .062, TYPE III+
	3 PLC ± -	PRODUCT SPEC	SIZE A2
	4 PLC ± -	APPLICATION SPEC	CAGE CODE 00779
	ANGLES ± -		DRAWING NO C=66102
MATERIAL SEE CALLOUTS	FINISH SEE TABLE	WEIGHT -	RESTRICTED TO -
		CUSTOMER DRAWING	SCALE 8:1 SHEET 1 OF 1 REV AS1